

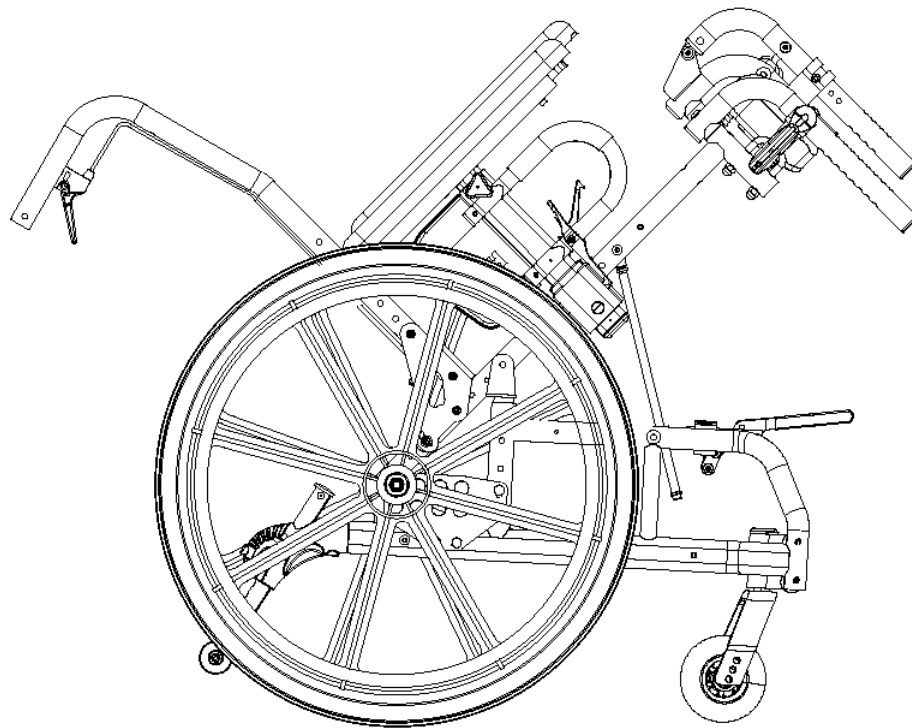

Owner's Operations Manual



SUPER CHAIR FOR KIDS BY ORION



NOTE: Check all parts for shipping damages before using.
In case of damage, do NOT use the equipment.
Contact the Equipment Supplier for further instructions.

WARNING
DO NOT install this equipment without first reading and understanding this instruction booklet. If you are unable to understand these instructions, contact a healthcare professional, dealer or technical personnel before attempting to install this equipment - otherwise, injury or damage may occur.

NOTICE
Information contained within this document is subject to change without notice.

SUPER CHAIR FOR KIDS BY ORION LABELS

WEIGHT CAPACITY
150 LBS. (68 KGS)
REFER TO OWNER'S MANUAL

WARNING
DO NOT OPERATE WITHOUT
ANTI-TIP MECHANISM IN PLACE.
UNIT MAY TIP BACKWARDS.

RECLINE **USE CAUTION** TILT
WHEN PROPELLING THIS CHAIR
IN THE TILT/RECLINE POSITION
USER WEIGHT 150 LBS MAXIMUM
Super Chair for Kids

TABLE OF CONTENTS

Labels.....	2
Specifications.....	4
General Guidelines.....	6
Safety Inspection.....	8
Front Rigging.....	9
Arms.....	11
Back.....	13
Rear Wheels.....	15
Tilting Wheelchair.....	17
Front Casters.....	18
Anti-tippers & Wheel Locks.....	20
Warranty.....	23

SUPER CHAIR FOR KIDS BY ORION SPECIFICATIONS

Chair Size

- Overall Max. Width 18" ~ 24"
- Overall Max. Length 44"
- Overall Max. Height 42"
- Weight ≤ 39 lbs.
- Tilt Frame (3° – 40°)

Weight Capacity (client weight)

- 150 lbs.

Seat Widths

- 10", 11", 12", 13", 14", 15" & 16"

Seat Depths

- 11", 12", 13", 14", 15" & 16"

Seat-to-Floor Heights

- Front seat to floor height 17-1/2" – 20" using 4", 5", 7" or 8" casters
- Rear seat to floor height 15-3/4" – 18-1/2"
- Quick-release or fixed rear wheels
- Caster housing – angle adjustable with or without hook
- Rear wheels adjustment (Height)
- Rear Wheels 12", 20" and 22"

Back Canes

- Fixed Back Low + High
- Depth, Angle adjustable – angles (-6°, 0°, 6°, 12°, 18°, 24°, 30°)
- Push Handles 10° bend (Hi and Low heights)

Colors

Frame

- Black, Blue, Burgundy, Orange, Yellow, Red, Silver

Accessories

- Auto Seat Positioning Strap (Standard)
- Velcro Release Positioning Strap
- Pull to Lock Wheel Lock (Standard)
- Push to Lock Wheel Lock
- Padded Headrest (Kids or Small) - Standard
- Spoke Guards
- Gel/foam armpads
- Side Storage Pocket
- Removable Push bar

- Rear Transit Hook (Standard)
- Front Transit Hook (Standard)

Other Common Specifications

Arms – T-STYLE 17”-GEL/FOAM, 14” and 10” VINYL

- 16 1/2” long
- 3” wide
- Adjustable heights from 9” to 13” (1/2” increments)
- Rounded at front and tapered to back
- Softer/plush
- Cantilever Arm, angle adjustable - angles (-6°, 0°, 6°, 12°, 18°, 24°, 30°)

Foot/Leg Supports

- Swingaway, detachable front rigging (Center Pivot)
 - 70°,80°,90°
 - heel loops - Standard
 - calf straps
 - H straps
- Swingaway, Elevating Leg Rest
 - Tilt Range (0°-40°)
- Footplates (Flipup)
 - Aluminum
 - Composite
 - Adjustable angle flip-back and side angle adjustable on footplates
 - Height adjustable – along swingaway

Anti-Tips

- 2 rear (quick removable)

Handrim Options

- Plastic coated and stainless steel

Back Options

- Super Chair Kids Back (Standard) or Slip on Padded Back Upholstery (Standard)
- Prism Backs (Basic, Ultra, Air Back, True Fit) – Custom Back Sizes

Seat Options

- Super Chair Kids Cushion (Standard)
- Prism Cushions (Ideal, Elite, Supreme, Supreme Air and Supreme II Plus) – Custom Cushion Sizes

GENERAL GUIDELINES

STABILITY

WARNING

The seat depth, back height/angle, seat angle, size/position of the front casters, size/position of the rear wheels, anti-tipper model, as well as the user condition directly relate to the stability of the wheelchair. Any change to one (1) or any combination of the ten (10) criteria may cause the wheelchair to decrease in stability. These adjustments **MUST** be performed by a qualified technician.

The various seat-to-floor heights require specific settings depending on rear wheel size, rear wheel position, front caster size/position and desired seat-to-floor angle. These adjustments **MUST** be performed by a qualified technician.

ANTI-TIPPERS

WARNING

In as much as the anti-tippers are an option on this wheelchair (you may order with or without the anti-tippers), Future Mobility Healthcare Inc. strongly recommends ordering the anti-tippers as a safeguard for the wheelchair user.

OPERATING INFORMATION

WARNING

Unless otherwise noted, all service and adjustment should be performed while the wheelchair is unoccupied.

To determine and establish your particular safety limits, practice bending, reaching and transferring activities in several combinations in the presence of a qualified healthcare professional **BEFORE** attempting active use of the wheelchair.

Always verify that hand grips on the rear cane are secure **PRIOR** to use when an attendant is used to propel or lift the chair. Check for any signs of looseness or deterioration and if found, contact a qualified technician. **DO NOT** attempt to move the wheelchair by using the hand grips if they are found to be unsecure or have deteriorated.

- **DO NOT** sit or transfer into the wheelchair unless it is fully open and the seat frame rails are fully seated into the side frame H-blocks.
- **DO NOT TRAVERSE, CLIMB or GO DOWN** ramps or slopes greater than 9 degrees
- **DO NOT** attempt to move up or down an incline with a water, ice or oil film

- **DO NOT** operate on roads, streets or highways
- **DO NOT** attempt to ride over curbs or obstacles. Doing so may cause your wheelchair to tip over and cause bodily harm to you or damage to the wheelchair.
- **DO NOT** attempt to reach objects if you have to move forward in the seat.
- **DO NOT** attempt to reach objects if you have to pick them up from the floor by reaching down between your knees.
- **DO NOT** lean over the top of the back upholstery. This will change your center of gravity and may cause you to tip over.
- **DO NOT** shift your weight or sitting position toward direction you are reaching as the wheelchair may tip over.
- **WHEEL LOCKS ARE NOT BRAKES. DO NOT** attempt to stop a moving wheelchair with wheel locks.
- **DO NOT** tip the wheelchair without assistance.
- **DO NOT** use an escalator to move a wheelchair between floors. Serious bodily injury may occur.
- Before attempting to transfer in and out of the wheelchair, every precaution should be taken to reduce the gap distance. Turn both casters parallel to the object you are transferring onto. When transferring to and from the wheelchair, **ALWAYS ENGAGE BOTH WHEEL LOCKS.**
- **DO NOT** use parts, accessories or adapters other than those authorized by Future Mobility Healthcare Inc. Otherwise, the warranty is void.
- **DO NOT** attempt to lift the wheelchair by any removable (detachable) part. Lifting by means of any removable (detachable) parts of a wheelchair may result in injury to the user and/or assistant or damage to the wheelchair.
- **DO NOT** stand on the frame of the wheelchair.
- **DO NOT** use the footplate as a platform. When getting in or out of the wheelchair, make sure that the footplates are in the upward position.

WEIGHT TRAINING

WARNING

Future Mobility Healthcare Inc. **DOES NOT** recommend the use of its wheelchairs as a weight training apparatus. Future Mobility Healthcare Inc. wheelchairs have **NOT** been designed or tested as a seat for any kind of weight training. If occupant uses said wheelchair as a weight training apparatus, Future Mobility Healthcare Inc. shall **NOT** be liable for bodily injury or damage to the wheelchair and the warranty is void.

WEIGHT LIMITATION

WARNING

The Super Chair for Kids by Orion wheelchair has a weight limitation of 150 lbs. (68kg).

SAFETY INSPECTION CHECKLIST

Initial adjustments should be made to suit your personal body structure needs and preference. Thereafter follow these maintenance procedures:

Item	Initially	Weekly	Monthly	Periodically
GENERAL <ul style="list-style-type: none"> Wheelchair rolls straight (no excessive drag or pull to one side) 	X		X	
FRAME AND CROSSING TUBES <ul style="list-style-type: none"> Inspect for loose or missing hardware Inspect for bent frame or crosstubes 	X X			X X
WHEEL LOCKS <ul style="list-style-type: none"> Do not interfere with tires when rolling Pivot points free of wear and looseness Wheel locks easy to engage Wheel locks prevent chair from moving when engaged 	X X X X	X	X X	X
SEAT AND BACK <ul style="list-style-type: none"> Inspect for rips or sagging Inspect for loose or broken hardware Inspect cane and hand grips for wear/looseness 	X X X		X X	X
TIRES <ul style="list-style-type: none"> Inspect for flat spots, cracks and wear Caution: as with any vehicle, the wheels and tires should be checked periodically for cracks and wear and should be replaced. 	X	X		X
REAR WHEELS <ul style="list-style-type: none"> If equipped, quick-release axles lock properly No excessive side movement or binding when lifted and spun Inspect for cracked, bent or broken spokes 	X X X	X X		X
HANDRIMS <ul style="list-style-type: none"> Inspect for signs of rough edges or peeling 	X			X
FRONT CASTERS/FORKS <ul style="list-style-type: none"> Inspect caster fork assembly for proper tension by spinning caster; caster should come to a gradual stop Adjust bearing system if wheel wobbles or binds to a stop. Ensure wheel bearings are clean and free of moisture. Check stem caster journal and lock nut for tightness Inspect casters for cracks and wear Inspect for cracked, bent or broken spokes 	X X X X X	X X	X X	X X
CLEANING <ul style="list-style-type: none"> Clean upholstery and armrests 	X			X

TROUBLESHOOTING

Chair Veers Right/Left	Super Chair for Kids by Orion Wheels	Sluggish Turn or Performance	Caster Flutter	Squeaks and Rattles	Looseness in Chair	Solutions
		X	X	X	X	Check for loose nuts and bolts
X	X		X			Check angle adjustable caster assembly
X	X					Check that rear wheels are equally spaced away from seat frame.

FRONT RIGGINGS

WARNING

After **ANY** adjustments, repair or service and **BEFORE** use, make sure all attaching hardware is tightened securely – otherwise injury or damage may occur.

INSTALLING/REMOVING THE FRONT RIGGINGS

Installing:

1. Place the front rigging assembly perpendicular to the wheelchair pointing outwards.
2. Insert the pivot plug on the swingaway into the top opening of the upper frame front.
3. At the same time line up the back curve of the swingaway latch assembly to the upper frame front radius.
4. Swing the front rigging assembly towards the inside the chair and the swingaway latch should snap into the latch u-bolt.
5. Repeat this procedure with other front rigging assembly.

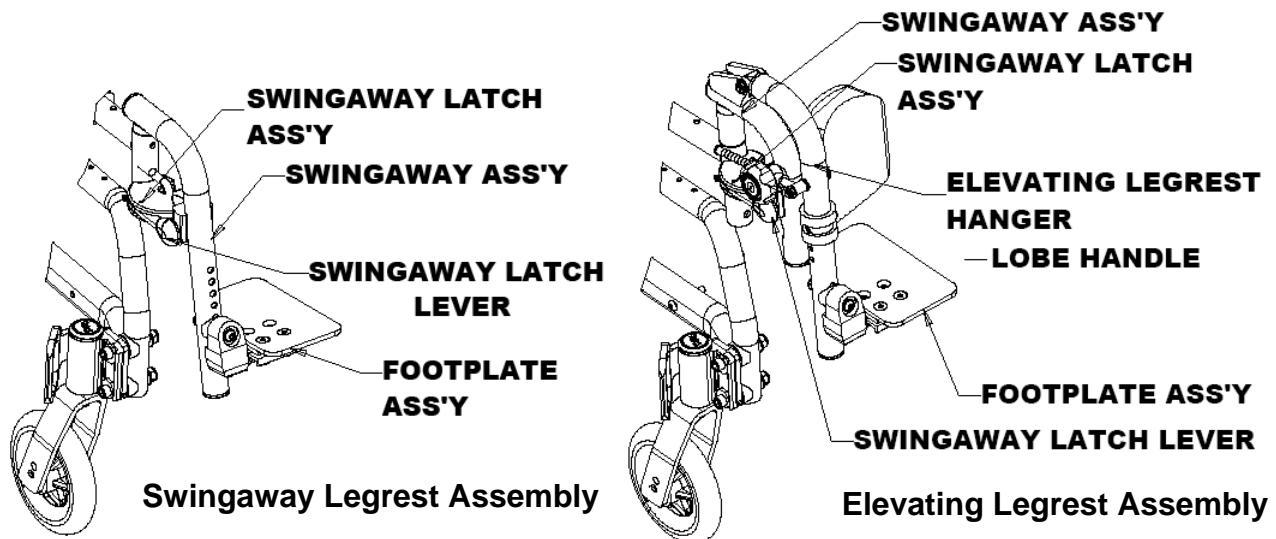

Removing:

1. Pull the swingaway latch lever outwards.
2. Rotate the front rigging assembly outward.
3. Lift the swingaway front rigging assembly off the side frame top opening.
4. Repeat this procedure with the other front rigging assembly.

ADJUSTING FOOTPLATE HEIGHT – SWINGAWAY & ELEVATING LEGREST ASSEMBLY

1. Remove the front rigging assembly. Refer to INSTALLING/REMOVING THE FRONT RIGGING in this section of the manual.
2. Remove the socket head button screw. Slide footplate assembly up or down to desired height.
3. Re-tighten socket head button screw.
4. Repeat this procedure with the other footplate assembly.

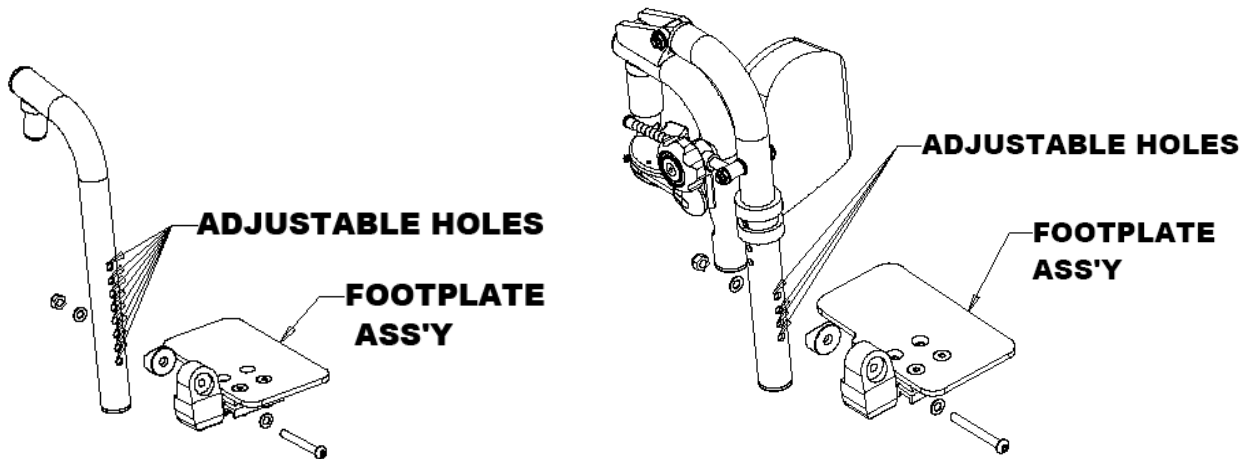

Adjusting Footplate Height – Swingaway

Adjusting Footplate Height - Elevating

ADJUSTING LEGREST ANGLE – ELEVATING LEGREST ASSEMBLY ONLY

1. Turn the elevating legrest lobe handle counter clockwise. The elevating legrest hanger portion should become loose.
2. Swing the elevating legrest hanger to the desired position along the index rod.
3. Turn the elevating legrest lobe handle clockwise to secure the position. Ensure that the lobe handle is tight.
4. Repeat this procedure with the other elevating legrest assembly.

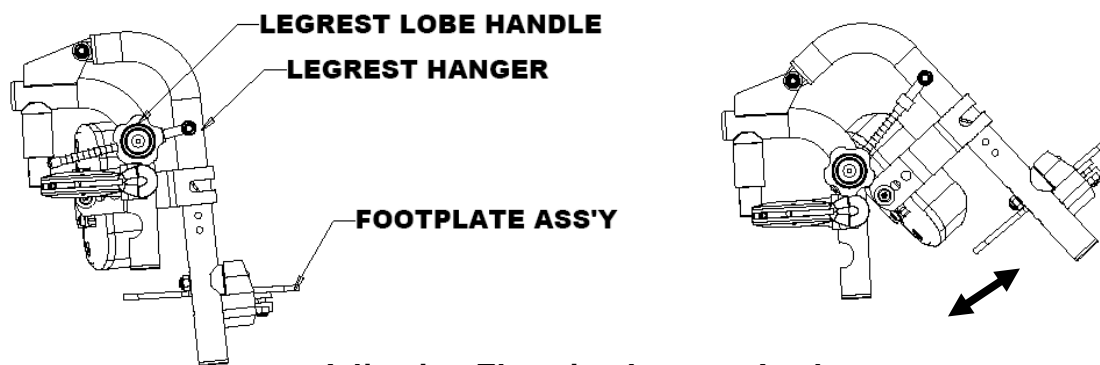

Adjusting Elevating Legrest Angle

ADJUSTING CALF PAD HEIGHT – ELEVATING LEGREST ASSEMBLY ONLY

1. Remove the front rigging assembly. Refer to INSTALLING/REMOVING THE FRONT RIGGING in this section of the manual.
2. Remove the socket head cap screw. Slide calf pad assembly up or down to desired height.
3. Re-tighten socket head cap screw.
4. Repeat this procedure with the other elevating legrest assembly.

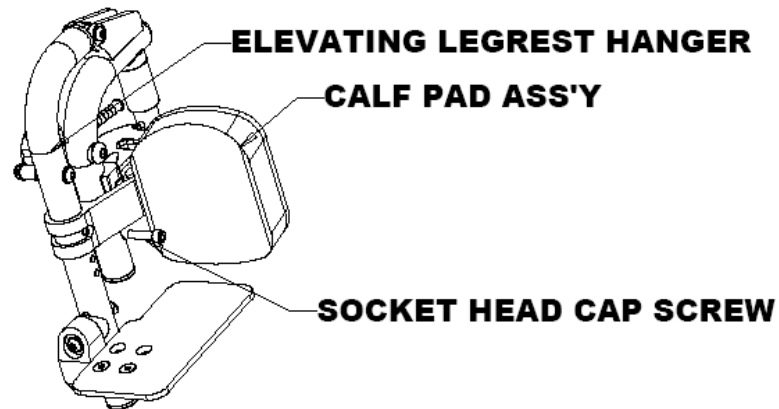

ARMS

WARNING

After **ANY** adjustments, repair or service and **BEFORE** use, make sure all attaching hardware is tightened securely – otherwise injury or damage may occur.

ADJUSTING T-STYLE ARM HEIGHT

1. Loosen the ball plunger knob.
2. Lift armrest until desired position is acquired (ranges from 9"– 13" in ½" increments).
3. Re-tighten the ball plunger knob.
4. Repeat this procedure with the other t-style arm assembly.

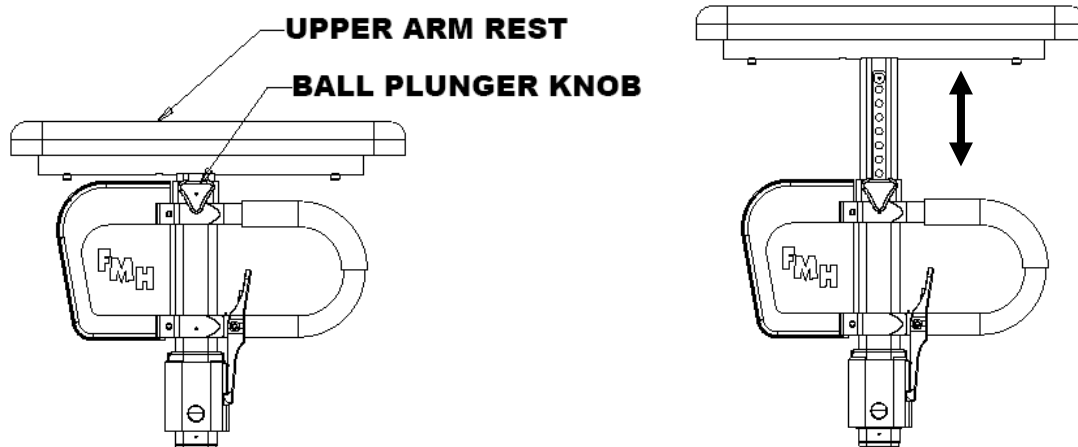

Adjusting T-Style Arm Height

ADJUSTING CANTILEVER ARM ANGLE

1. Loosen the lock nut connected to the lock pin – located near the armrest mount plate.
2. Swing the cantilever armrest to desired position.
3. Tighten the lock nut.
4. Repeat this procedure with the other cantilever arm assembly.

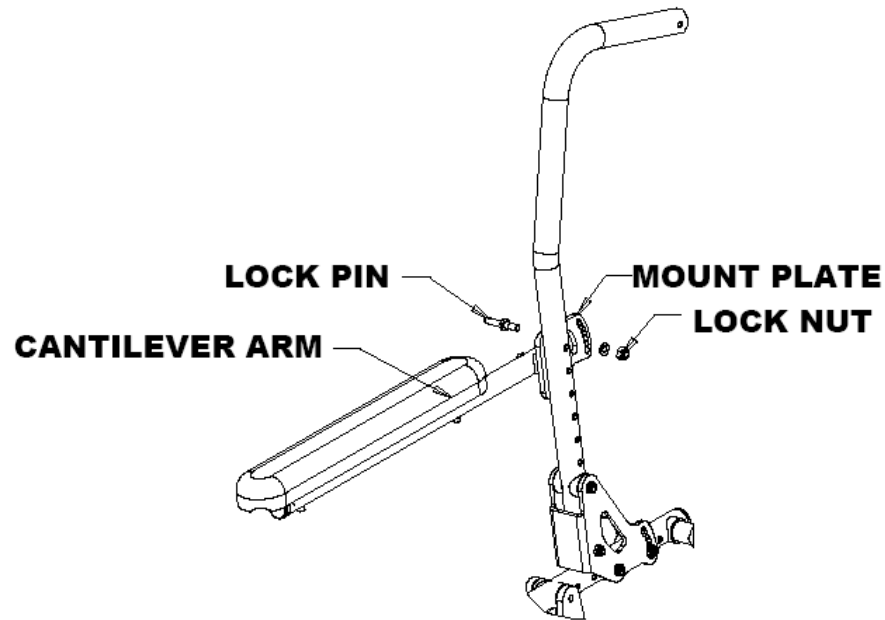

Adjusting Cantilever Arm Angle

BACK

WARNING

After **ANY** adjustments, repair or service and **BEFORE** use, make sure all attaching hardware is tightened securely – otherwise injury or damage may occur.

REPLACING THE BACK UPHOLSTERY

1. Remove the two (2) mounting screws and washers that secure the existing back upholstery to the back canes.
2. Remove the four (4) mounting screws, four (4) spacers and four (4) nuts which connect the back cane to side frame.
3. Pull the loose back canes out of the existing back upholstery.
4. Remove the lock device pin on the back canes to allow the upholstery to be removed.
5. Slide the NEW back upholstery along the back canes until the mounting holes are seen through the upholstery.
6. Insert the two (2) mounting screws and washers to secure the back upholstery to the back canes.
7. Slide the back cane and upholstery assembly through the backpost angle bracket.
8. Insert the four (4) mounting screws, four (4) spacers and four (4) nuts to connect the back cane to the side frame.
9. Use two (2) cable ties to attach the back upholstery to the backpost angle bracket.

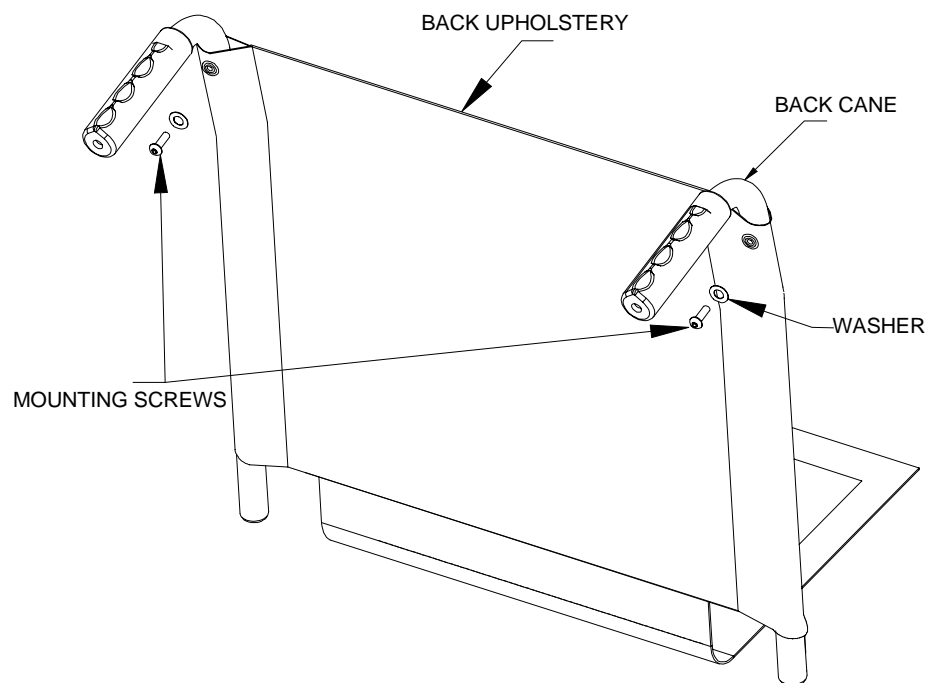

Replacing Back Upholstery

ADJUSTING BACK CANE ANGLE

1. Remove the cap screw, locknut and washers that secure the slotted portion of the backpost angle bracket to the lower frame.
2. Firmly hold the back cane assembly and adjust the position of the back cane as desired.
3. Place back the cap screw, locknut and washers to hold the backpost angle bracket in place.
4. Take note of the slot position of the backpost angle bracket.
5. Repeat this procedure with the other backpost angle bracket and back cane.

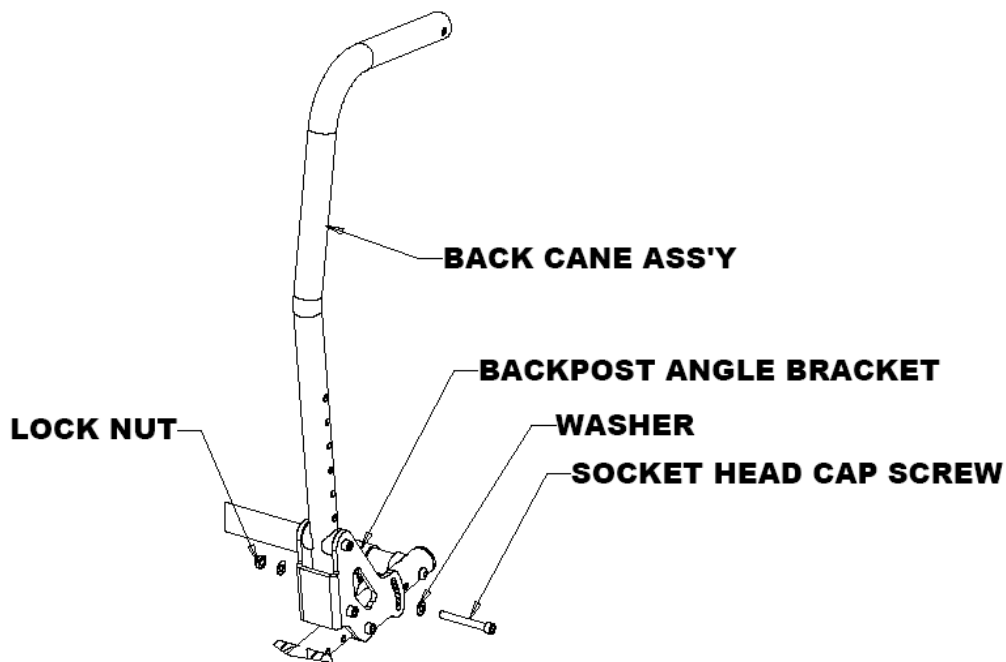

Adjusting Back Angle

REAR WHEELS

WARNING

After **ANY** adjustments, repair or service and **BEFORE** use, make sure all attaching hardware is tightened securely – otherwise injury or damage may occur.

REMOVING/INSTALLING THE REAR WHEELS

WARNING

If changing the size of the rear wheel or a change in the seat-to-floor height is desired, this procedure **MUST** be performed by a qualified technician.

1. Push in the detent pin of the quick-release axle (with wheel) and pull the axle out through the opening in the center of the rear wheel and axle spacer.
2. Push in the detent pin of the quick-release axle again and pull the axle out of the rear wheel.
3. To reinstall the rear wheel onto the wheelchair, reverse steps 1 to 2.
4. Repeat this procedure for the other rear wheel assembly if required.
5. If using the Push-to-Lock or Pull-to-Lock mechanism ensure the wheel locks properly. See the section ADJUSTING THE WHEEL LOCKS.

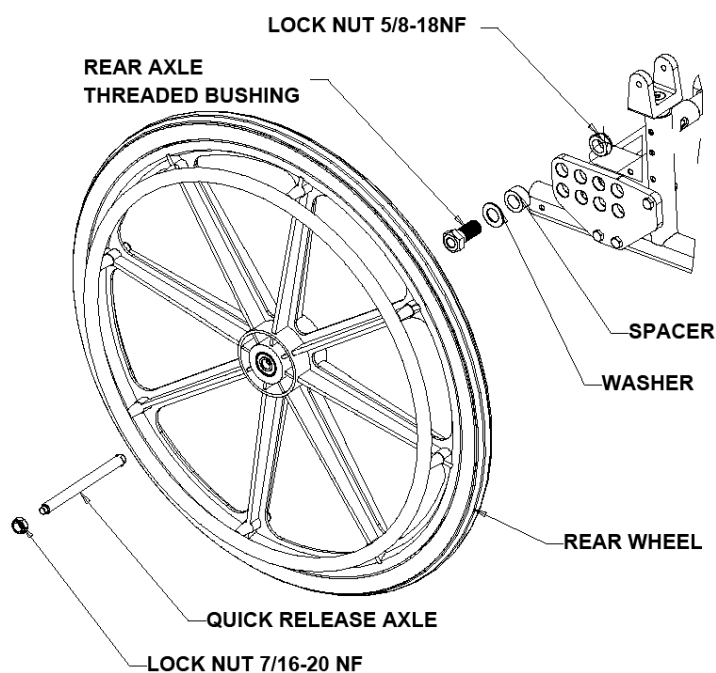

**Installing/ Removing Rear Wheel
20", 22"**

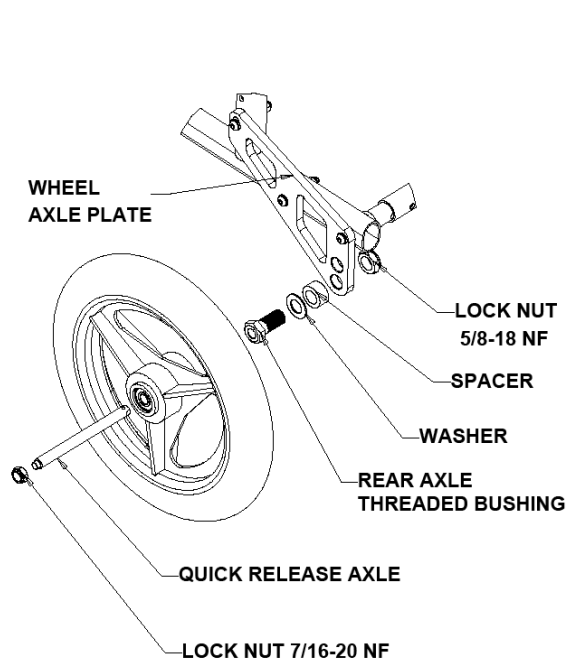

**Installing/ Removing Rear Wheel
12"**

WARNING

Make sure the detent pin and locking pins of the quick-release axle are fully released BEFORE operating the wheelchair.

The locking pins MUST be protruding past the inside of the rear wheel axle bushing for a positive lock.

Keep locking pins clean.

Future Mobility Healthcare Inc. recommends inserting quick-release axles with the detent pin to the inside of the wheelchair to prevent accidental release during contact activities.

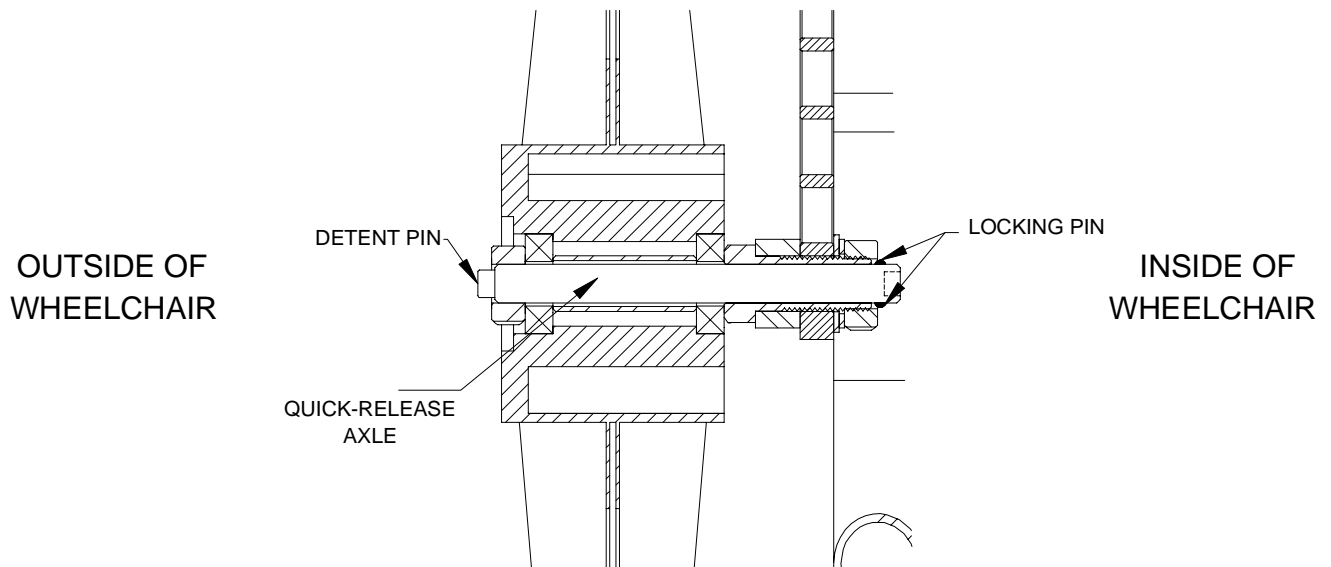

Detail – Locking Pin and Detent Pin

TILTING THE WHEELCHAIR

1. Use both hands and grasp the handle trigger assemblies on the back canes.
2. Pull the handle with fingers and pull the back canes backwards. One should notice the upper frame front rotating upwards as well as the pistons expanding.
3. When at desired angle, release fingers from the handles. The upper frame should 'lock' into place. The tilt range of the upper frame is from 3° to 40°.
4. Ensure the wheelchair is stable enough at the desired angle so its occupant can not be injured.
5. To return the chair to a lower angle, use both hands and grasp the handle trigger assemblies on the back cane.
6. Pull the handle with fingers and push the back canes forwards. One should notice the upper frame front rotating downwards as well as the pistons contracting.
7. When at desired angle, release fingers from the handles. The upper frame should 'lock' into place.

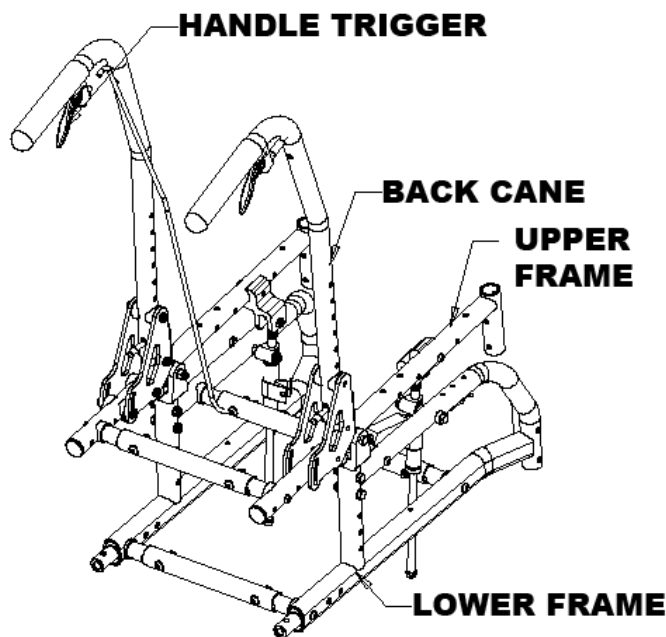

Wheelchair at 3° Tilt

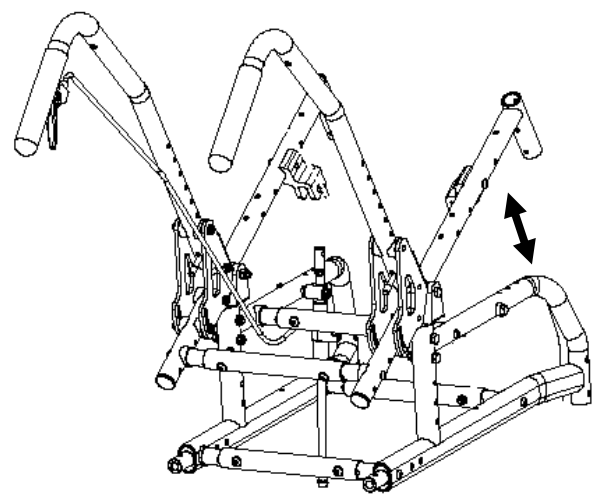

Wheelchair at 30° Tilt

FRONT CASTERS

WARNING

After **ANY** adjustments, repair or service and **BEFORE** use, make sure all attaching hardware is tightened securely – otherwise injury or damage may occur.

INSTALLING/REPLACING FRONT CASTERS AND FORKS

REPLACING/INSTALLING FRONT CASTERS

Note: This procedure can be performed if replacing the exact same size front caster.

1. Remove the nut, bolt and spacers which secure the caster to the fork assembly.
2. Remove the front caster.
3. Slide in the new 4, 5, 7 or 8 inch front caster into the space between the fork.
4. Tighten the nut, bolt and spacers to secure the caster into place.
5. Repeat this procedure for the other front caster wheel assembly if required.
6. To properly tighten caster journal system and guard against flutter, perform the following check:
 - a. Tip back of wheelchair to floor
 - b. Pivot both forks and casters to top of their arc simultaneously.
 - c. Let casters drop to bottom of arc (wheels should swing once to one-side, then immediately rest in a straight downward position).
 - d. Adjust locknuts according to freedom of caster swing.
7. Test wheelchair for maneuverability.
8. Re-adjust locknuts if necessary and repeat STEPS 6 to 7 until correct.
9. Snap dust cover over the locknut and stem.

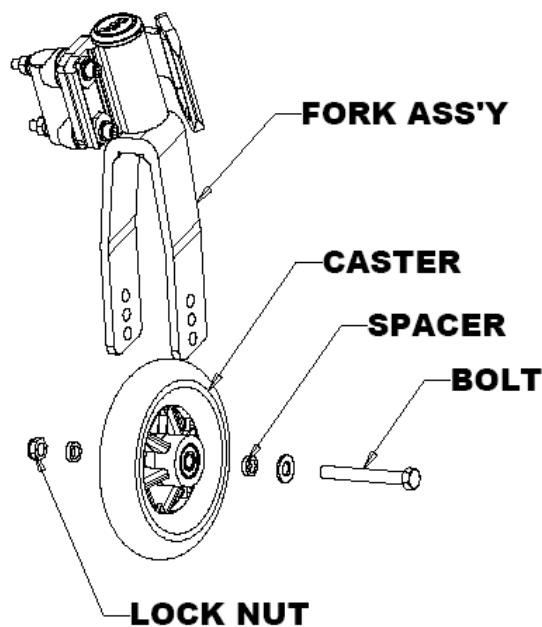

Front Caster Assembly

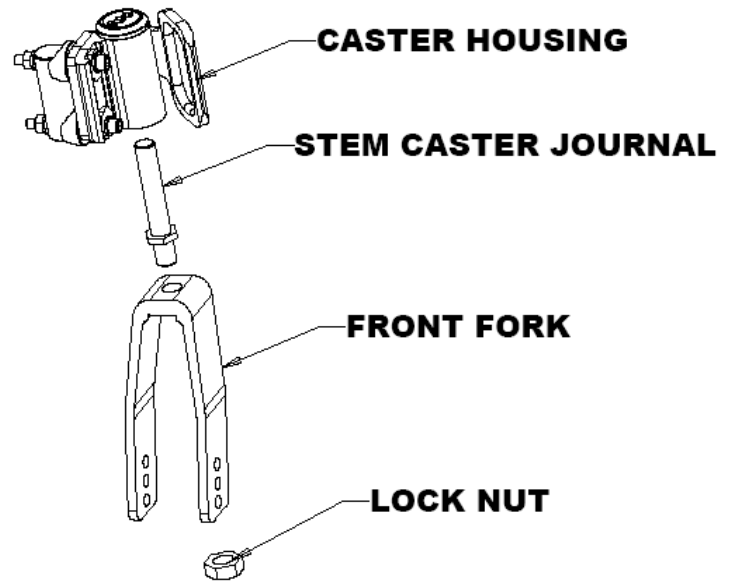

Front Fork Assembly

REPLACING/INSTALLING FRONT FORKS

1. Remove the locknut that secures the fork to the caster stem bolt.
2. Drop the front caster and fork assembly out of the caster stem bolt leaving the fork stem still in the angle adjustable caster housing assembly.
3. Follow REPLACING/INSTALLING FRONT CASTERS guide in this section to remove the front caster from the fork assembly.
4. Place the caster in the new fork and assemble with the caster nut and bolt
5. Secure the new fork and caster assembly in place by using the locknut and caster stem bolt.
6. Follow steps 5 to 9 of REPLACING/INSTALLING FRONT CASTERS guide to properly install the new fork assembly and prevent fluttering.

SEAT TO FLOOR

1. Follow the values in the table below to achieve the desired seat to floor height
2. Ensure that no weight is on the wheelchair while performing the operations
3. Ensure after changing the seat to floor height that the wheelchair is still operational and that no wheel flutter or instability occurs.
4. For the 20" and 22" rear wheels there are three holes in the axle plate along the same row. The wheel should be inserted in the hole furthest to the back of the chair for more stability. If the user wants more manoeuvrability then the wheel can be moved to the hole closest to the front of the chair. The chair should always be tested to ensure it is operational and safe for the end user.

STF FRONT (in)	REAR WHEEL (in)	CASTER SIZE (in)	FORK SIZE	FORK HOLE	AXLE PLATE HOLE	STF REAR (in)
18.50	12	4	LG	C	A	17.25
18.50	12	5	LG	B	A	17.25
19.00	12	7	SML	C	A	17.50
19.50	12	7	LG	B	B	18.25
20.00	12	8	LG	B	B	18.50
17.50	20	4	SML	C	A	15.75
18.00	20	5	SML	C	A	15.75
18.50	22	5	LG	B	A	16.75
19.00	20	7	SML	C	B	17.00
19.50	22	7	LG	B	B	18.00
20.00	22	7	LG	C	B	18.00

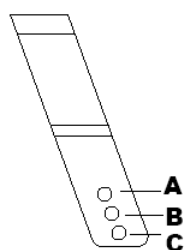

LONG FORK

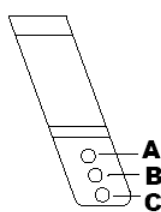

SHORT FORK

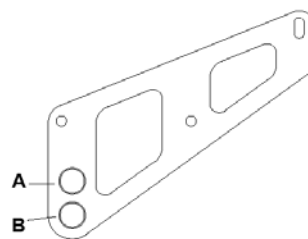

12" WHEEL
AXLE PLATE

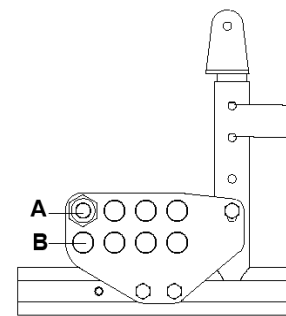

20", 22" WHEEL
AXLE PLATE

ANTI-TIPPERS/WHEEL LOCKS

WARNING

After **ANY** adjustments, repair or service and **BEFORE** use, make sure all attaching hardware is tightened securely – otherwise injury or damage may occur.

INSTALLING/ADJUSTING THE ANTI-TIPPERS

WARNING

Anti-tippers are specific to the different seat-to floor angles and/or seat-to-floor heights. Refer to the chart in this section of the manual for correct usage and adjustment. If these requirements **CANNOT** be achieved, **DO NOT** use the wheelchair. Contact a qualified technician. If changing the seat-to-floor height with or without a change to seat-to-floor angle, the correct anti-tippers **MUST** be used to maintain a 1 ½" to 2" ground clearance.

Seat-to-floor angle of 3 degrees to 6 degrees: if so equipped, anti-tippers **MUST** be attached at all times. In as much as the anti-tippers are an option on this wheelchair (you may order with or without the anti-tippers), Future Mobility Healthcare Inc. strongly recommends ordering the anti-tippers as a safeguard for the wheelchair user.

Anti-tippers **MUST** be fully engaged and snap buttons fully protruding out of adjustment holes.

Ensure both anti-tippers are adjusted to the same mounting hole.

INSTALLING ANTI-TIPPERS

1. Press the release button IN and insert the anti-tippers with the anti-tipper wheels pointing toward the ground/floor into the rear frame tubing until the bottom release button locks in place.
2. Measure the distance between the bottom of the anti-tipper wheels and the ground/floor.
3. If the distance between the bottom of the anti-tipper wheels and the ground/floor is not 1 ½ " to 2", adjust the anti-tippers. Refer to ADJUSTING THE ANTI-TIPPERS in this section of the manual.
4. Repeat steps 1-3 for other anti-tip assembly.
5. Ensure the Slide tubes are 'locked' in place with the release buttons so the wheelchair can operate safely.

*Note: A 1 ½ " to 2" clearance between the bottom of the anti-tipper wheels and the ground/floor **MUST** be maintained at all times.*

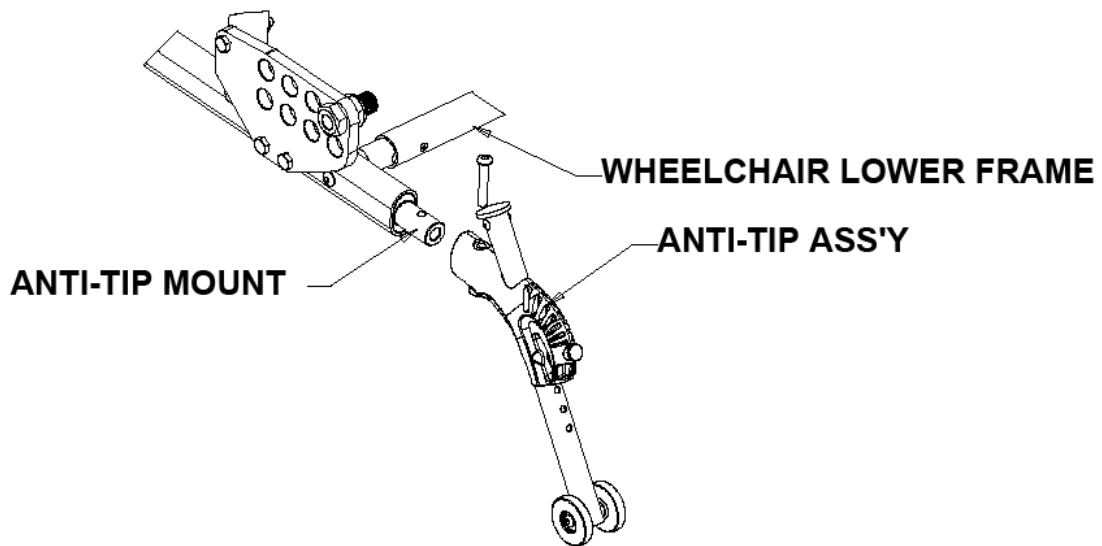

Installing Anti-Tip Assembly

ADJUSTING THE ANTI-TIPPERS

1. Press the release button IN on the anti tip assembly and adjust the anti-tip slide tube up or down until a 1 ½" to 2" clearance from the ground is achieved.
2. Check to make sure that the release buttons are fully engaged in the adjustment holes.

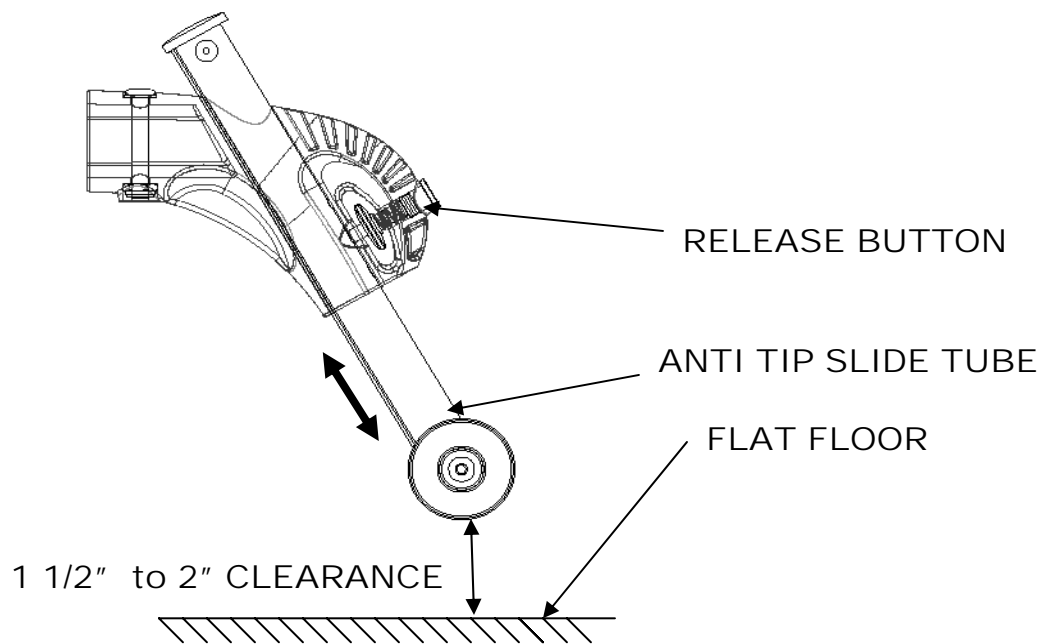

Adjusting Anti-Tippers

USING THE WHEEL LOCKS

WARNING

DO NOT attempt to stop a moving wheelchair with the wheel locks. **WHEEL LOCKS ARE NOT BRAKES** – otherwise injury or damage may occur.

1. Ensure the wheelchair is not moving before engaging the wheel locks.
2. Perform one (1) of the following:
 - a. Push-to-Lock – to engage, push the wheel lock handle forward
 - b. Pull-to-Lock – to engage, pull the wheel lock handle backward
3. Disengage the wheel locks by reversing STEP 2.

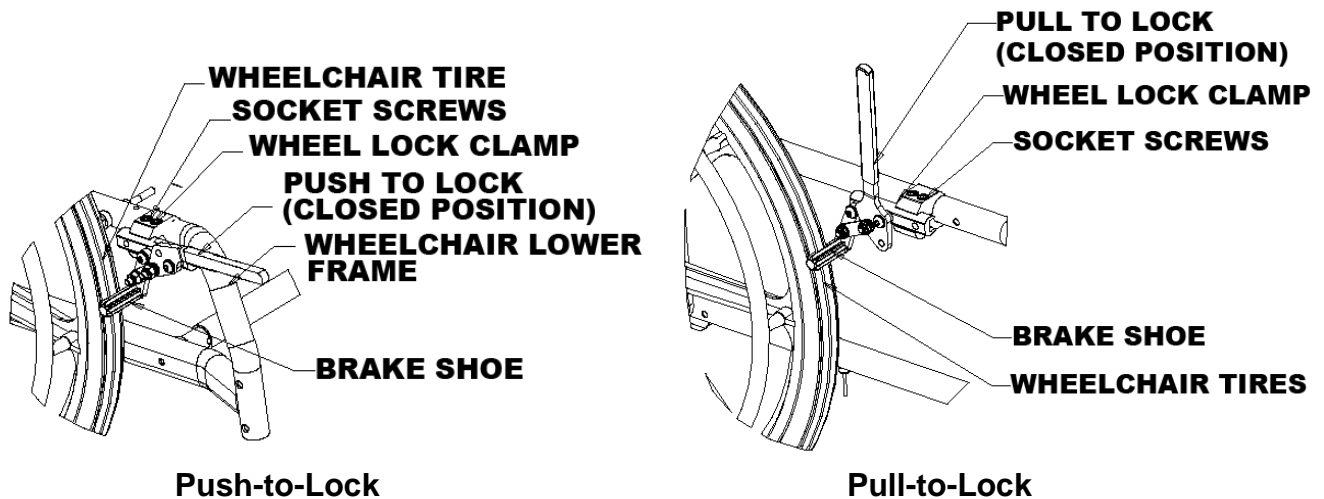

ADJUSTING THE PATIENT OPERATED WHEEL LOCKS

1. Disengage the wheel locks.
2. **CLAMP-ON** Wheel Locks – loosen the two (2) socket screws shown in the above figure that secure the wheel lock to the wheelchair frame.
3. Reposition the wheel lock so that when engaged, the wheel lock brake shoe embeds the tire 1/8" (3/16" for pneumatic tires) and **HOLDS** the occupied wheelchair in place when pushed.
4. Securely tighten the two (2) socket screws securing the wheel lock to the wheelchair frame.
5. Engage the wheel lock.
6. Measure the distance the wheel lock is embedded into the tire
7. Repeat STEPS 1 to 6 until the wheel lock brake shoe embeds the tire and **HOLDS** the occupied wheelchair in place when pushed.
8. Engage both wheel locks and ensure the occupied wheelchair is held in place when pushed.

WARRANTY

This warranty is extended only to the original purchaser/user of our products.

Future Mobility Healthcare Inc. warrants its Super Chair for Kids by Orion Wheelchair to be free from defects in materials and workmanship for one (1) year from the date of purchase. The frame is warranted for the lifetime of the original purchaser/user and the upholstery for 90 days, upon normal usage by original purchaser. If within this warranty period the product shall be proven to be defective, such product shall be repaired or replaced, at Future Mobility Healthcare Inc. discretion. Future Mobility Healthcare Inc. sole obligation and your exclusive remedy under this warranty shall be limited to the repair and/or replacement of the product or its parts. This warranty does not include any labour or shipping charges incurred in replacement part installation or repair of any product.

For warranty service, please contact the dealer from whom you purchased your Future Mobility Healthcare Inc. product. In the event you do not receive satisfactory warranty service, please write directly to Future Mobility Healthcare Inc. at 3223 Orlando Drive, Mississauga, Ontario, L4V 1C5. Provide the dealer's name, address, model number, date of purchase and indicate the nature of the defect.

DO NOT return products to Future Mobility Healthcare Inc. without our prior consent. The defective unit or parts must be returned for warranty inspection within thirty (30) days of the return authorization date. (Future Mobility Healthcare Inc. will issue a return authorization number). Please prepay all shipping charges; C.O.D. shipments will be refused.

LIMITATIONS and EXCLUSIONS: This warranty shall not apply to problems arising from normal wear or failure to adhere to the enclosed instructions. Products subjected to negligence, accident, improper usage, maintenance or storage; or products modified without Future Mobility Healthcare Inc. written consent including, but not limited to: modification through the use of any unauthorized parts or attachments; products damaged by reason or repairs made to any component without the specific consent of Future Mobility Healthcare Inc., or products repaired by anyone other than a Future Mobility Products dealer. Such evaluation shall be determined by Future Mobility Healthcare Inc..

The foregoing warranty is exclusive and in lieu of all other expressed warranties. It shall not extend beyond the duration of the expressed warranty provided herein and the remedy for violations of any implied warranty shall be limited to repair or replacement of the defective product pursuant to the terms contained herein. Future Mobility Healthcare Inc. shall not be liable for any consequential or incidental damages whatsoever.

This warranty shall be extended to comply with all provincial laws and requirements.

Future Mobility Healthcare Inc.
3223 Orlando Drive
Mississauga, ON L4V 1C5
905 671-1661 – 1 888 737-4011
Fax: 905 671-3377

e-mail: customersupport@future-mobility.com
www.future-mobility.com

The logo for Future Mobility Healthcare features the company name in a bold, blue, sans-serif font. The letter 'O' in 'Mobility' is replaced by a stylized blue wheel icon with a white center. Below the company name, the tagline 'Innovative seating and mobility solutions' is written in a smaller, italicized, blue font.

Future Mobility Healthcare
Innovative seating and mobility solutions